



FULHAM REACH
LONDON W6

HOLLAND COURT

Apartment 533 | 2 BEDROOM
Asking Price £999,000
Completion Status: Build-Complete



Apartment Details



Ready to Move In



Views overlooking private landscaped courtyard garden



Highest yielding home



Contemporary home at our starting price

FIRST FLOOR

TOTAL AREA	61.6 SQM	663.0 SQFT
Kitchen	2.77m x 2.81m	9' 1" x 9' 3"
Living / Dining	4.83m x 3.03m	15' 10" x 9' 11"
Bedroom 1	3.03m x 2.93m	9' 11" x 9' 7"
Bedroom 2	2.16m x 2.98m	7' 1" x 9' 9"
Balcony	5.8 sqm	62.4 sqft

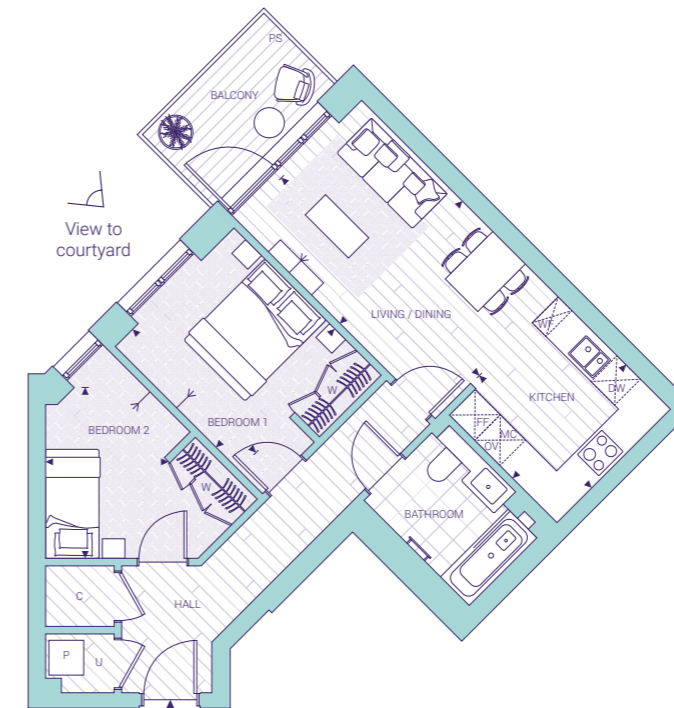

KEY

▶ Measurement Points ◀ TV Aerial Point W Wardrobe C Cupboard U Utility Cupboard
FF Fridge/Freezer MC Microwave WF Wine Fridge DW Dishwasher OV Oven
P Heat Interface Unit & MVHR with Washer/Dryer below PS Privacy Screen

Development Information

COUNCIL TAX

Band H £2,612.00

TENURE*

999 years lease from 2011

SERVICE CHARGES**

Holland Court: Estimated £5.89 psf per annum

ESTIMATED WEEKLY RENT***

£730

TERMS OF PAYMENT

When expected completion is within 6 months

1. £5000 reservation fee
2. Exchange within 21 days on 20% of the purchase price, minus reservation fee already paid
3. Balance is payable on completion

Fulham Reach Sales & Marketing Suite
Distillery Wharf, Parr's Way, W6 9GD

CLICK HERE
TO BOOK YOUR APPOINTMENT
TODAY or call 020 7870 9500

Disclaimer: Please be aware that these details are intended to give a general indication of properties available and should be used as a guide only. The company reserves the right to alter these details at any time. The contents herein shall not form any part of any contract or be a representation including such contract. These properties are offered subject to availability. Applicants are advised to contact the sales office or the appointed agents to ascertain the availability of any particular type of property so as to avoid a fruitless journey. The property areas are provided as gross internal areas under the RICS measuring practice 4th edition recommendation. *The ground rent premium is as per the ground rent schedule in the legal pack and will increase in accordance with RPI every 21 years. **Anticipated service charge* is an estimate only and subject to change. The estimate is dated 2019 and does not make allowances for increases due to RPI, inflation etc. from the date of preparation to legal completion. Terms of charge that can affect the service charge include, but are not limited to, changes in industry or government legislation, unexpected cost and any other matter outside of the control of St George. The appointed Managing Agent may also charge additional fees, outside of the service charge, for items including, but not limited to, licences and consents, sub-letting, legal proceedings and re-selling / sales pack. *** Current market value as of 20/07/2023. Prices are correct at time of going to print. Computer generated images are indicative only.



HOLLAND COURT